

**Other Rain Bird Xerigation® products to use with Rain Bird's Control Zone Kits:**

**Landscape Dripline** - the most clog-resistant, pressure compensating in-line emitter tubing in the world. 12", 18" or 24" emitter spacing available with your choice of .06 or .09 GPH emitters.

**PPC-200X** - tubing cutter

**XM-Tool** - This multi-function drip installation tool reduces emitter installation time by 50%.

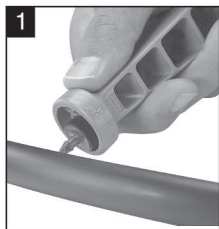

One step Xeri-Bug Insertion



Continuous Feed Insertion

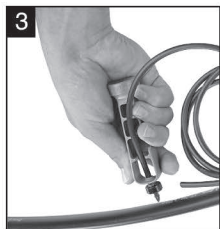

One step insertion with preinstalled 1/4" tubing



Xeri-Bug removal



Goof Plug Insertion

**Install Rain Bird Emitters 50%  
Faster with the Xeriman™ Tool**

**Rain Bird Corporation**

970 West Sierra Madre Avenue, Azusa, CA 91702  
Phone: (626) 963-9311 Fax: (626) 812-3411, (626) 812-3608

**Rain Bird Corporation**

6991 E. Southpoint Rd., Bldg. 1, Tucson, AZ 85706  
Phone: (520) 741-6500 Fax: (520) 741-6549

**Rain Bird International, Inc.**

145 North Grand Avenue, Glendora, CA 91740  
Phone: (626) 852-7100 Fax: (626) 963-4287

**Rain Bird Technical Services**

(800) 247-3782 (U.S. only)

**Specification Hotline**

800-458-3005 (U.S. only)

[www.rainbird.com](http://www.rainbird.com)

The Intelligent Use of Water™ – Visit [www.rainbird.com](http://www.rainbird.com)  
to learn about our efforts.

© Registered Trademark of Rain Bird Corporation  
© 2004 Rain Bird Corporation 7/04



Xerigation Control Zone

Model: XCZ 100 B COM

Instruction Sheet



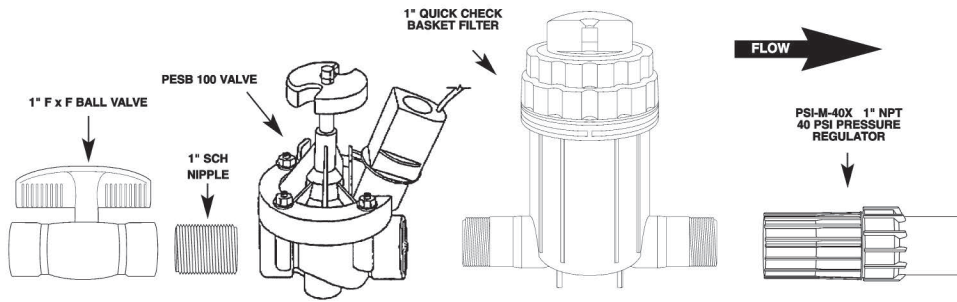

Note: the X CZ 100 BCOM may be shipped with either a 1\"/>

## INSTRUCTIONS

1. Teflon™ tape (1½ to 2 turns) all male threads.
2. Install the Quick Check Basket filter in the upward position (as shown above) to allow for access to the filter element and Quick Check indicator. The filter body features a large arrow indicating the correct direction of flow.

**Note:** *Flush system with filter element removed prior to connecting downstream components. Caution: incorrect filter installation (reverse) or failure to flush may seriously damage or clog other drip components.*

3. Turn on the water, pressurizing the system. The bubble on top the filter will show green, indicating the filter element is clean.

**Note:** *the bubble indicator will remain in the green position when the system is turned off. Verifying whether the system needs cleaning must be done while the system is turned on.*

4. During operation, water flows downstream and enters the filter chamber. Water pressure forces the water through the element, collecting debris. Clean water flows through the element and continues downstream. At shut off, debris falls into the basket area at the base of the filter element. The cycle repeats itself until the amount of debris builds up.
5. When the debris build up causes sufficient pressure loss to affect performance, the indicator changes to red. A red indicator means the filter element needs to be cleaned.
 

**Note:** *You must check the indicator while the system is operating, as the indicator will always show green when the system is shut off.*
6. To clean the filter element, turn off the water, unscrew and remove the cap. Lift the filter element out of the filter body. The basket design prevents debris from falling back into the line. Turn the filter upside down and rinse with water to wash the debris away. Return the filter element to the filter body and screw the cap back in place. Tighten the cap until the indicator is aligned with the inlet/outlet. Turn the water back on and the bubble indicator should return to green, indicating a clean filter.

For Technical Assistance,  
Call Toll Free  
(800) 247-3782

Thank you for using our products.